

FRONT - CUT AWAY ALL PINK AREAS

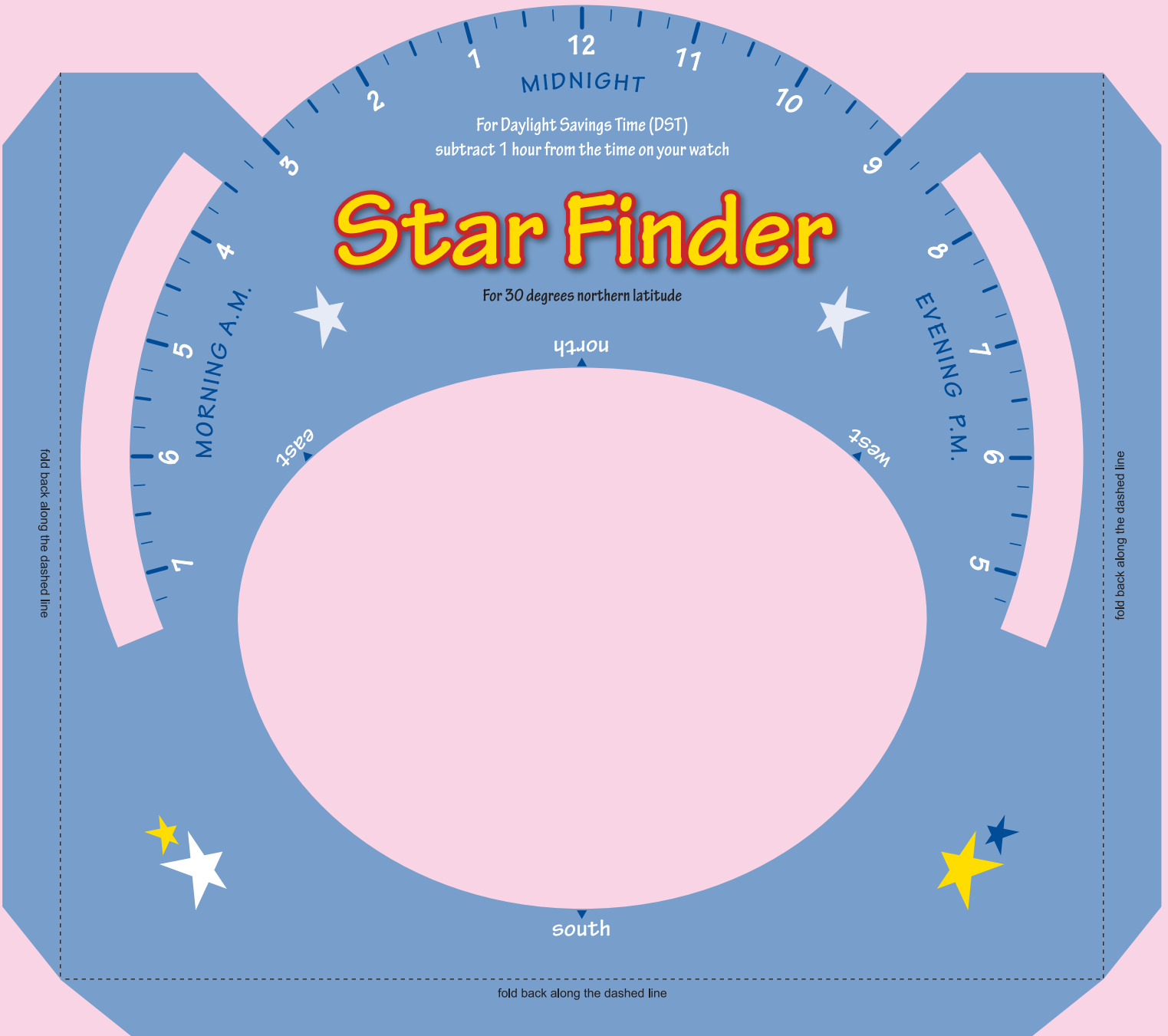

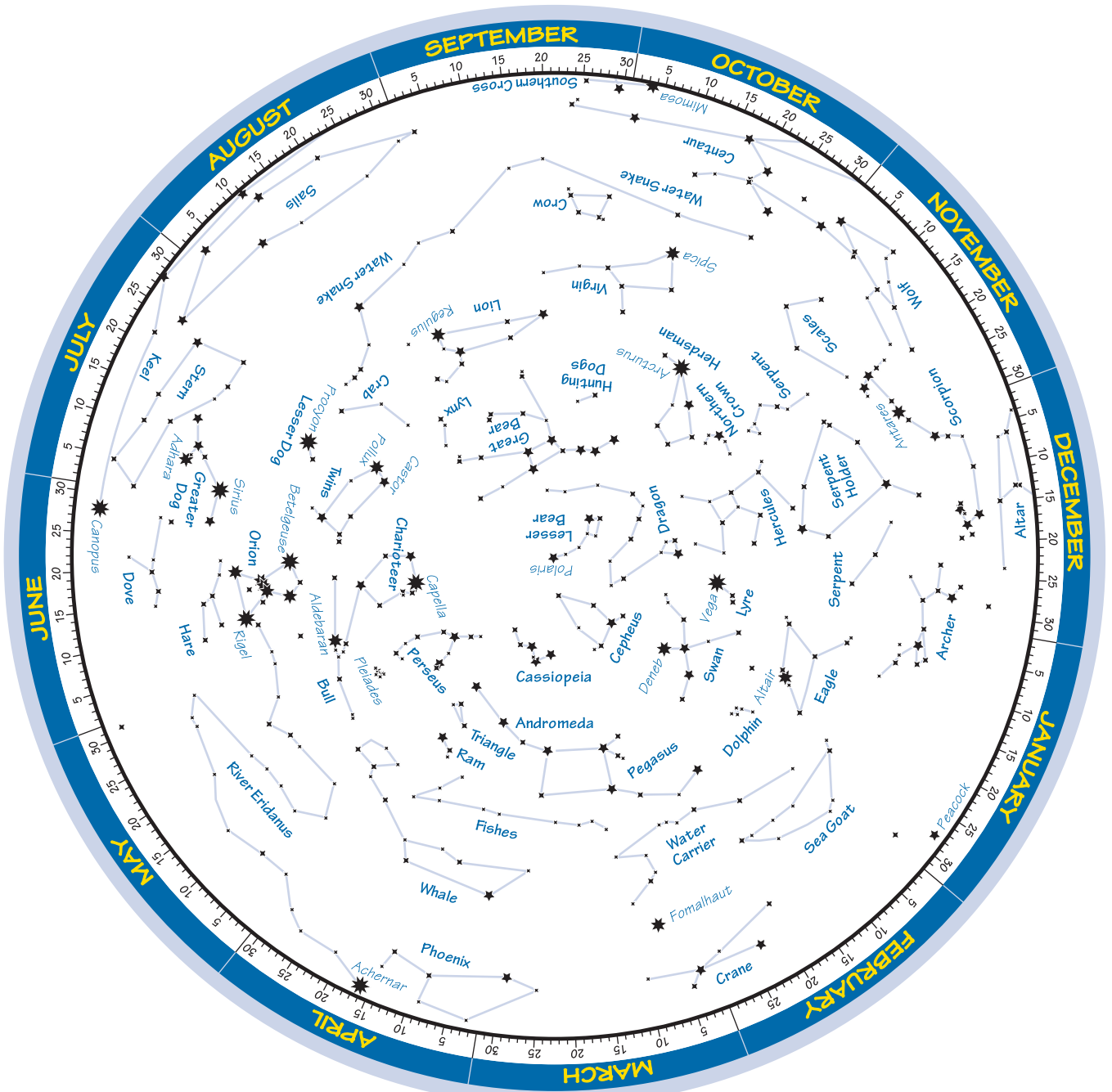

cut disk carefully along the outside of the light blue circle

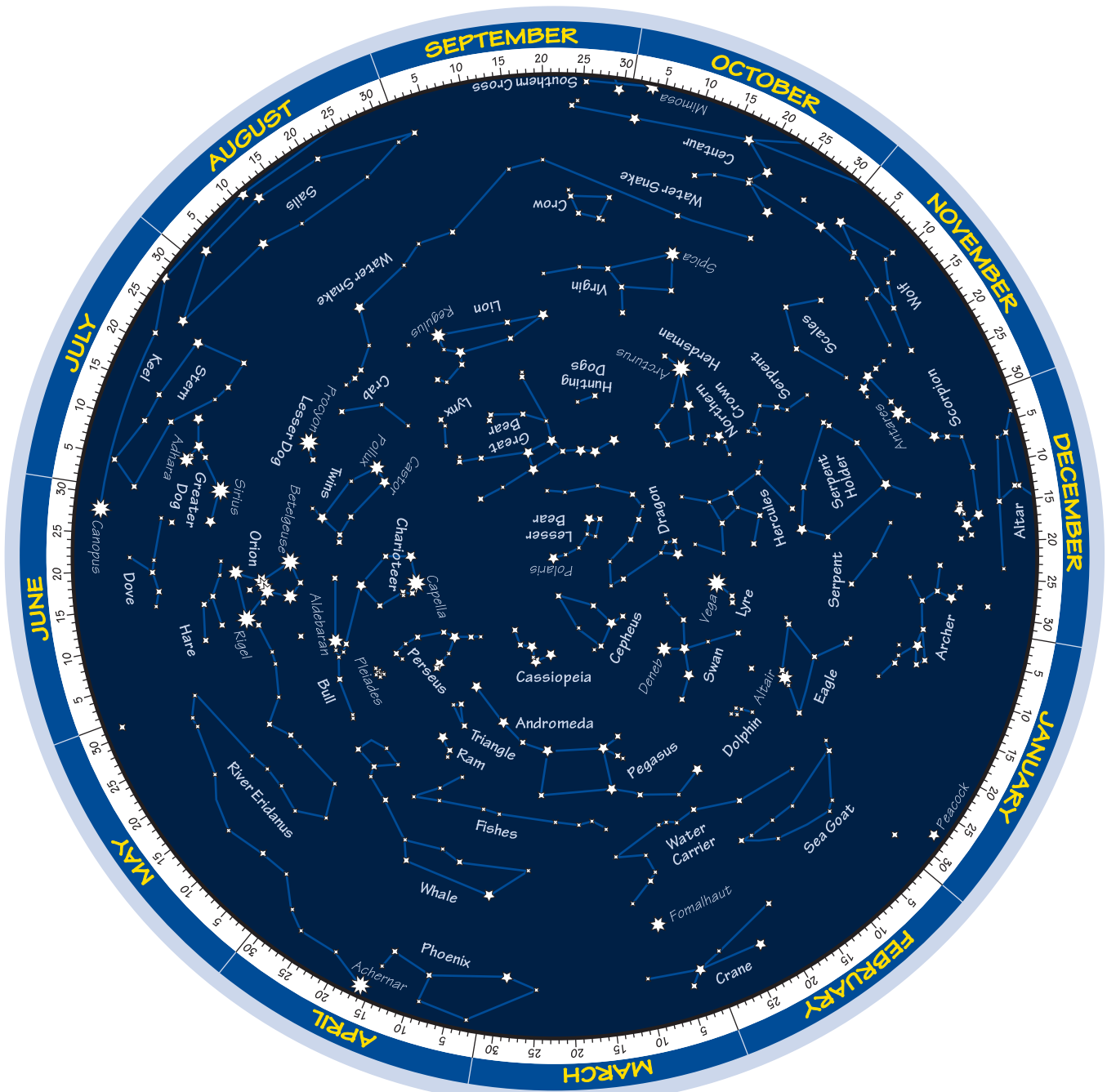

cut disk carefully along the outside of the light blue circle

BACK - CUT CAREFULLY ALONG THE BLUE RECTANGLE

How to assemble

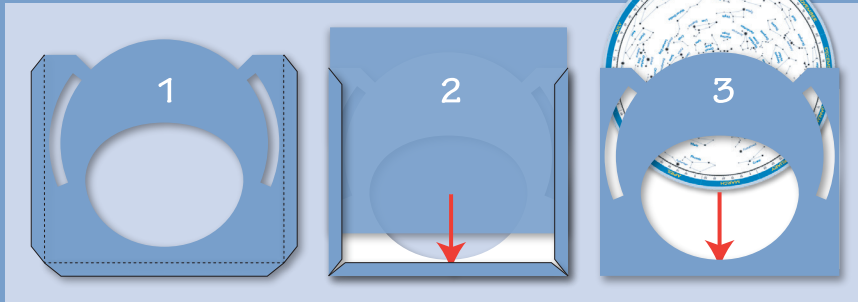

Cut out the three parts, following the instructions on the prints.

1 - Fold back the three strips of the cover.

2 - Turn around and insert the back side. Use glue or transparent tape to attach the three strips to the back.

3 - Turn around again and carefully insert the star disk.

How to use

Example: **You want to look at the stars on January 15, at 10 P.M.**

Rotate the star disk so that January 15 on the date scale (the scale on the star disk) faces 10 P.M. on the time scale (the scale on the front cover).

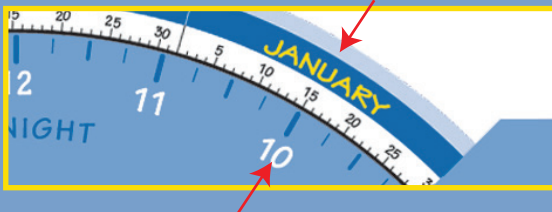

The oval opening in the front cover reveals the stars that are visible at that time, and the edge of the oval is the horizon. The four small triangles mark the main directions. When you look south, hold the planisphere up, with the small triangle marked **south** at the bottom, and when you look in another direction turn the **whole Star Finder** (not just the star disk) so that the direction you are facing is at the bottom.

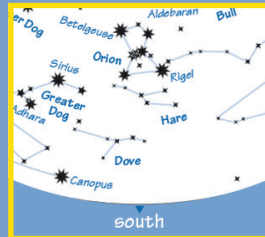

Looking south



Looking east

Try to find the brightest stars first. Keep in mind that the planisphere is small, compared to the real sky, so the distances in the sky often appear much larger than you would expect. The center point of the oval is the zenith, that is the point in the sky that is straight above your head.

 **Discovery**™

Design and artwork **Wil Tirion** www.wil-tirion.com